

est 1979

Jeremy  
Leaf & Co.



Nether Street, North Finchley

£1,549,000

- Three Self-Contained Flats
- Flat 2: 3 Bedroom/2 Bathroom first floor flat
- Flat 3: 1 Bedroom, 1 Bathroom top floor flat
- Investment/Development Opportunity
- Let on Assured Shorthold Tenancy Agreements
- Flat 1: 3 Bedroom/2 Bathroom Garden Flat
- Freehold Property

863 High Road, London, N12 8PT  
020 8446 4295

property@jeremyleaf.co.uk  
<https://www.jeremyleaf.co.uk/>

# Nether Street, North Finchley, N12 7NP

**FREEHOLD INVESTMENT/DEVELOPMENT OPPORTUNITY!** A three-storey house converted into three self-contained flats (currently rented on ASTs - information available on request). Comprising: 3 bed/2 bath ground floor flat with garden (current rent £1900pcm), 3 bed/2 bath first floor flat (current rent £1850pcm) and 1 bed/bath second floor flat (current rent £1160). Virtual tours for each floor are available by clicking the link. NB: New leases can be created if flats are to be sold separately.



Council Tax Band: D







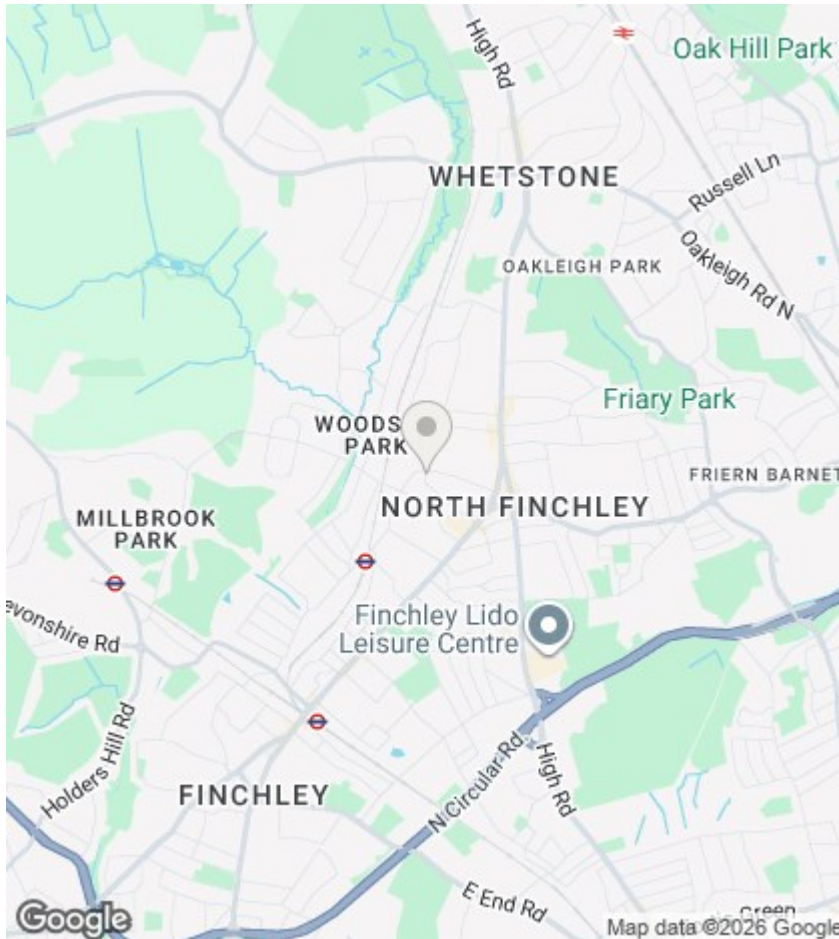

## Directions

## Viewings

Viewings by arrangement only. Call 020 8446 4295 to make an appointment.

## EPC Rating:

Energy Efficiency Rating		
	Current	Potential
Very energy efficient - lower running costs		
(92 plus) <b>A</b>		
(81-91) <b>B</b>		
(69-80) <b>C</b>		
(55-68) <b>D</b>		
(39-54) <b>E</b>		
(21-38) <b>F</b>		
(1-20) <b>G</b>		
Not energy efficient - higher running costs		
<b>England &amp; Wales</b>	EU Directive 2002/91/EC	

Approx Gross Internal Area  
69 sq m / 742 sq ft

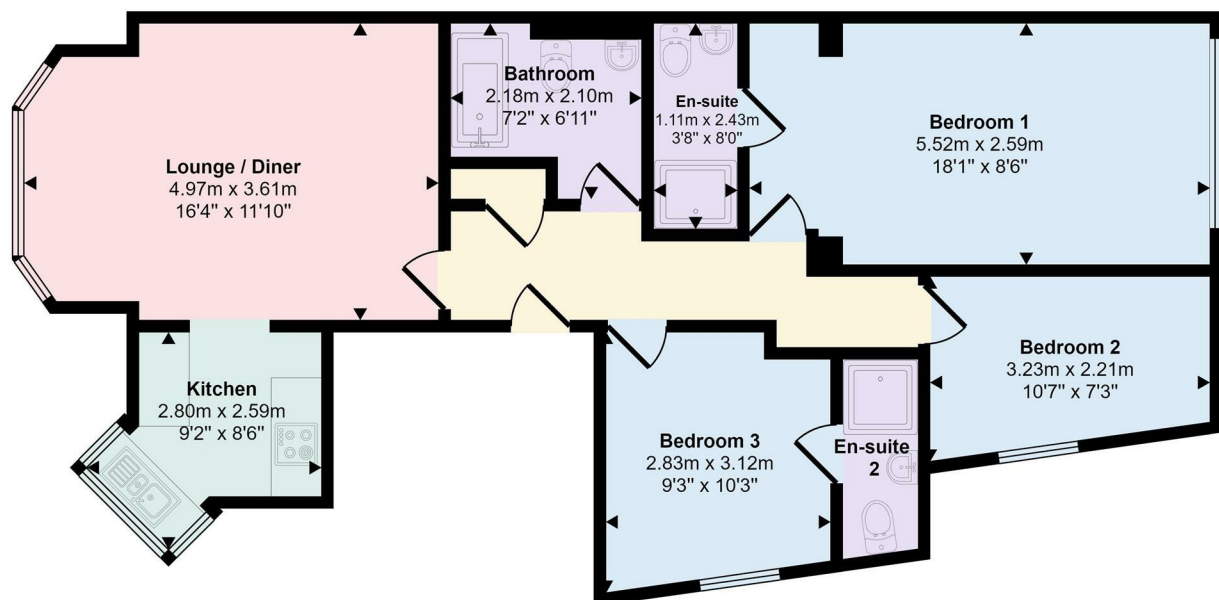

## Floorplan

This floorplan is only for illustrative purposes and is not to scale. Measurements of rooms, doors, windows, and any items are approximate and no responsibility is taken for any error, omission or mis-statement. Icons of items such as bathroom suites are representations only and may not look like the real items. Made with Made Snappy 360.